



**LIFETIME  
WARRANTY**

Backed by a Lifetime Warranty, Sunex Impact Sockets are warranted against defects in materials and workmanship for the life of the product. This warranty does not apply to items that have been misused, abused, altered in any way, or worn out from use. Some Adapters, Reducers, and Extra Thin Wall Impact Sockets are sold with out of box warranty.

# IMPACT SOCKETS

Since 1984, we've led the market with our solution-based designs and quality materials. All of our Impact Sockets (low-profile, standard, deep, hex drivers, universal joint, specialty, and extensions/adapters) are backed by an industry-leading warranty, so you can rest easy knowing your sockets are guaranteed to perform.

# IMPACT SOCKETS

## HIGHEST QUALITY. HIGHEST STANDARDS.

### RADIUSED CORNERS

Focuses impact on fastener's flat surfaces, increasing torque and reducing wear and rounding to the fastener.

### DURABLE CR-MO STEEL

Precision manufactured with chrome-molybdenum steel for high-impact applications.

### HEAT TREATED / TEMPERED

Sockets are first heat treated to increase hardness and then tempered to maximize durability.



### SPECIALTY SOCKETS

Every job has its own challenges. We offer a wide selection of specialty sockets to handle anything the job calls for.

### METRIC

### SAE

1/4"  
DRIVE

3/8"  
DRIVE

1/2"  
DRIVE

3/4"  
DRIVE

1"  
DRIVE

### NO-SKIP SIZE SPECTRUM

Sunex Impact Socket Sets include every size in the specification range: Largest to smallest, and everything in between.

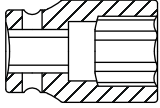

Standard



Deep

## 1" DRIVE SAE INDIVIDUAL SOCKETS

SIZE	STANDARD	DEEP	SIZE	STANDARD	DEEP
SAE	MODEL	MODEL	SAE	MODEL	MODEL
3/4"	524	524D	2-1/4"	572	572D
13/16"	526	526D	2-5/16"	574	574D
7/8"	528	528D	2-3/8"	576	576D
15/16"	530	530D	2-7/16"	578	578D
1"	532	532D	2-1/2"	580	580D
1-1/16"	534	534D	2-9/16"	582	582D
1-1/8"	536	536D	2-5/8"	584	584D
1-3/16"	538	538D	2-11/16"	586	586D
1-1/4"	540	540D	2-3/4"	588	588D
1-5/16"	542	542D	2-13/16"	590	590D
1-3/8"	544	544D	2-7/8"	592	592D
1-7/16"	546	546D	2-15/16"	594	594D
1-1/2"	548	548D	3"	596	596D
1-9/16"	550	550D	3-1/8"	5100	5100D
1-5/8"	552	552D	3-1/4"	5104	5104D
1-11/16"	554	554D	3-3/8"	5108	5108D
1-3/4"	556	556D	3-1/2"	5112	5112D
1-13/16"	558	558D	3-5/8"	5116	5116D
1-7/8"	560	560D	3-3/4"	5120	5120D
1-15/16"	562	562D	3-7/8"	5124	5124D
2"	564	564D	4"	5128	5128D
2-1/16"	566	566D	4-1/8"	5132	5132D
2-1/8"	568	568D	4-1/4"	5136	5136D
2-3/16"	570	570D	4-1/2"	5140	5140D

## 1" DR. DEEP 6 POINT SAE

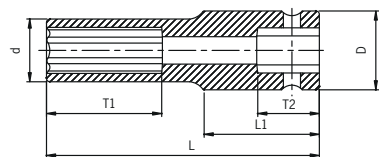

A

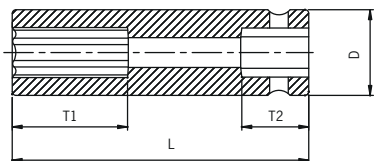

B

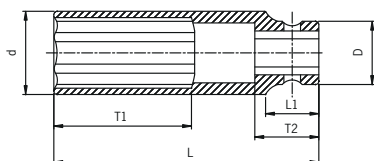

C

ITEM	SIZE	SHAPE	D	D	T1	T2	L1	L
524D	3/4"	A	36	51	25	31	38	90
526D	13/16"	A	38	51	25	31	38	90
528D	7/8"	A	39	51	25	31	38	90
530D	15/16"	A	40	51	25	31	38	90
532D	1"	A	42	51	30	31	38	90
534D	1-1/16"	A	44	51	30	31	38	90
536D	1-1/8"	A	46	51	30	31	38	90
538D	1-3/16"	A	48	51	35	31	38	90
540D	1-1/4"	B	/	51	35	31	/	90
542D	1-5/16"	C	53	52	35	31	30	90
544D	1-3/8"	C	54	52	40	31	30	90
546D	1-7/16"	C	56	52	40	31	30	90
548D	1-1/2"	C	58	52	40	31	30	92
550D	1-9/16"	C	60	52	40	31	30	92
552D	1-5/8"	C	61.5	52	40	31	30	92
554D	1-11/16"	C	65	52	40	31	30	92
556D	1-3/4"	C	66	58	40	31	30	92
558D	1-13/16"	C	68	58	40	31	30	92
560D	1-7/8"	C	70	58	40	31	30	92
562D	1-15/16"	C	72	58	40	31	30	92
564D	2"	C	74	58	50	31	30	95
566D	2-1/16"	C	75	58	50	31	30	95
568D	2-1/8"	C	78	58	50	31	30	95
570D	2-3/16"	C	80	62	50	31	30	100
572D	2-1/4"	C	84	62	50	31	30	100
574D	2-5/16"	C	86	62	55	31	30	105
576D	2-3/8"	C	87	62	55	31	30	105
578D	2-7/16"	C	89	62	60	31	30	110
580D	2-1/2"	C	91	62	60	31	30	110
582D	2-9/16"	C	93	62	70	31	30	120
584D	2-5/8"	C	95	62	70	35	33	120
586D	2-11/16"	C	97	62	75	35	33	124
588D	2-3/4"	C	98	62	75	35	33	124
590D	2-13/16"	C	100	62	80	40	35	128
592D	2-7/8"	C	102	62	80	40	35	128
594D	2-15/16"	C	104	86	85	45	38	135
596D	3"	C	106	86	85	45	38	135
5100D	3-1/8"	C	109	86	85	45	38	135
5104D	3-1/4"	C	113	86	85	45	38	135
5108D	3-3/8"	C	115	86	85	45	38	135
5112D	3-1/2"	C	119	86	85	45	38	135
5116D	3-5/8"	C	128	86	90	32	20	140
5120D	3-3/4"	C	130	86	90	32	20	140
5124D	3-7/8"	C	136	86	90	32	20	140
5128D	4"	C	140	95	100	32	20	155
5132D	4-1/8"	C	143	95	100	32	20	155
5136D	4-1/4"	C	146	95	100	32	20	155
5140D	4-1/2"	C	152	95	100	32	20	155